



I AM with you ALWAYS

A CAMPAIGN TO BUILD THE
FUTURE OF ST. FRANCIS



CAMPAIGN PRAYER

We come before you Jesus, grateful for the many blessings you provide for us as individuals and as a family of St. Francis of Assisi. As you instructed your disciples to go and preach the Gospel to all nations, we pray that we may continue to grow in our faith, and strengthened by the Sacraments to live out the mission that you gave us (Matthew 28:16-20).

Heavenly Father, we are grateful for the continued growth in our community and as we fix our hearts and minds toward our future, we ask for your blessing and guidance in our vision for St. Francis for generations to come. May you always continue to give us wisdom, perseverance, clear direction in our discernment and never let us forget the words that you promised your disciples:

“I am with you always, until the end of the age.”



St. Francis of Assisi Catholic Church Mission Statement

*“The 11 disciples went to Galilee, to the mountain to which Jesus had ordered them. When they saw him, they worshiped, but they doubted. Then Jesus approached and said to them, “All power in heaven and on earth has been given to me. Go, therefore, and make disciples of all nations, baptizing them in the name of the Father, and of the Son, and of the Holy Spirit, teaching them to observe all that I have commanded you. And behold, **I am with you always, until the end of the age”**”*

MATTHEW 28:16-20



Dear St. Francis Family,

I come to you today feeling deeply blessed to serve as your pastor. Each Sunday, I look out upon rows and rows of the faithful family of St. Francis of Assisi Catholic Church. Every service is filled with not only the members of our vibrant and diverse community, but also with the joy and reverence of a church committed to the mission given to us by Christ.

Your commitment, however, does not stop at the doors of our beautiful church. Our members leave every week to serve our church and community through flourishing ministries – providing meaningful education and formation of our children and youth, merciful outreach to those in need, and making missionary disciples of others. As you have gone forth on this holy mission, St. Francis has continued to grow in numbers, adding an average of 25 new families per week over the past year – over 1,000 in 2024 alone.

Because of this growth, St. Francis is at a turning point and must make plans for the future. In the following pages, you'll find the details of our plans to not only accommodate our existing family, but also the continued growth over the years to come. That is why we are launching a major capital campaign that is derived directly from **Matthew 28:16-20, our parish mission: *I Am with You Always***.

I encourage you to read the following pages carefully, outlining our vision for the St. Francis community. It is my prayer that every member of the St. Francis family can invite the Lord to lead you in discerning your sacrificial gift or pledge to fund these projects to accommodate our expanding membership.



I extend my deepest gratitude for your continued prayers, support and generosity, and I pray for the Lord's abundant blessing upon you, your loved ones and all of the St. Francis family.

Gratefully,

Fr. Rudy Garcia

Fr. Rudy Garcia
Pastor

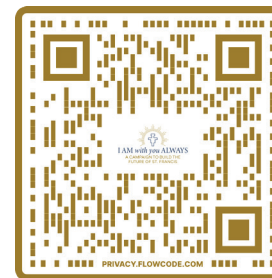

*View the I Am
with You Always
campaign video*



“St. Francis is our spiritual home where we have grown in our faith, deepened our love for Jesus and made many friends in this faith community. The parish is very welcoming, with a number of ministries that allow us to put our faith into action through service to the parish and community.

The formation programs are outstanding, challenging each to become lifelong disciples of Christ. Most importantly, we appreciate the reverent celebration of Holy Mass and deep love of the Eucharist. We are excited and looking forward to building new meeting and sacred spaces. The developments are crucial for St. Francis to remain a fountain of spiritual growth and nourishment for generations to come and allow us to continue to welcome those who seek Christ and want to grow in their faith.”

*Loren and Christie Lacy
campaign general chairs*

A GROWING COMMUNITY

In the summer of 1966, twelve families stepped out in faith to establish a mission parish in the small farming town of Frisco. God has blessed and transformed our once-tiny parish from those humble beginnings into one of the largest in the Diocese of Dallas and the country. Today, St. Francis of Assisi is home to over 9,000 active parish families and nearly 24,000 active individuals. Throughout our history, parishioners have stepped forward to guarantee that our church could meet the needs of our growing Catholic community. With their leadership, sacrifice, commitment and generosity, we were able to construct our original parish center in 2001, followed by our beautiful church and chapel in 2013.

Today, we stand at another pivotal moment in our history. We have been blessed by growth, but also challenged by it. We simply don't have enough space to accommodate our many ministries and activities, housing for our priests, and adequate room for our children, youth and young adults. We find ourselves in a similar situation to those original twelve families who formed our parish. Collectively, we must step forward in faith to ensure that St. Francis can provide adequate space and resources for prayer, formation, discipleship and outreach.

To that end, parish leaders have been diligently working on a long-range plan to accommodate these needs through new facilities on our campus. During this period of discernment and planning, we have sought the guidance of the Holy Spirit and listened intently to feedback and ideas from across the parish, most notably through our planning study last fall where we solicited feedback from every family and received feedback from thousands of parishioners to help determine the most important aspects of the plan for our future. In these pages, you will find the details of that plan, and an overview of what we hope will be the fruit of our labor and the blessing of the Holy Spirit.

In Matthew 28:20, part of our parish mission statement, the Lord promises his disciples that “He will be with them always, even until the end of the age.” As disciples of Christ today, we know these words grant us the same assurance that He is ever-present in our lives. Through the *I Am with You Always* Capital Campaign, St. Francis of Assisi Catholic Church will be able to share this pledge with future generations of disciples, providing reverent worship, meaningful discipleship, engaging formation, strong education and outreach to those throughout the community who have yet to know the blessed assurance of God's love.



“Remember that when you leave this earth, you can take with you nothing that you have received – only what you have given.” – St. Francis of Assisi

Under the leadership and direction of Bishop Edward J. Burns, the Diocese of Dallas is looking with great hope to the future. We recognize that Collin County is one of the top three fastest-growing counties in the United States. With this growth, the Diocese has the responsibility of ensuring access to quality education that represents our Catholic identity and values. The Catholic community in Collin County has long called for a Catholic school in our area, a school close to home where our children and future generations can grow and develop academically, spiritually, reflect the values of our faith and find a strong Catholic identity.

In 2019, the Diocese answered that call with the purchase of 26 acres of land and a vision of a regional school to benefit the families of St. Francis of Assisi and our neighboring parishes in northern Collin County. Recent survey responses overwhelmingly called for moving forward quickly with executing this vision.

The planned Mother Teresa Catholic School in Frisco at the corner of Independence and Main is a unique and exciting opportunity to open a new Catholic school and provide access to Catholic education for families in Collin County. St. Francis of Assisi, as the largest parish in the area, will lead the charge in support for the school through an initial fundraising effort as part of the *I Am with You Always* Capital Campaign, accompanied by a Diocesan capital campaign for all parishes in northern Collin County and the Diocese of Dallas. Together, we will create a strong foundation for future generations at St. Francis of Assisi and beyond in Collin County and throughout the Diocese of Dallas.



LEARN MORE ABOUT MOTHER TERESA CATHOLIC SCHOOL ON PAGE 9 OR VISIT THE SCHOOL WEBSITE HERE



OUR PLAN



Adoration Chapel

Family Life Center

The *I Am with You Always* campaign will focus on four projects to provide needed space to accommodate growth, support our Catholic community and fulfill our mission:



Adoration Chapel

1

Family Life Center | \$35 million

- At least 20 total new meeting rooms to be used for faith formation (K-5, middle school, high school, Confirmation), Bible studies, young adults, OCIA (formerly RCIA), ministry meetings, youth programs and more
- A new 800-seat auditorium to provide additional space to host Masses each Sunday and Holy Days such as Christmas, Easter, and Ash Wednesday, speaking events, youth programs and overflow
- A new formal banquet hall that will seat 500 dinner-style or 800 theater-style
- Communal gathering spaces to allow parishioners to gather before and after Mass and other activities and meeting spaces to grow relationships and fellowship
- A second-floor youth space for gathering, education, Bible study and meetings, including:
 - 10 meeting rooms prioritized for youth and faith formation
 - A dedicated youth area for gathering, music, fellowship and outreach
- A new adoration chapel to seat 126 for perpetual adoration worship, as well as six new dedicated confessionals



Outdoor Gathering Area

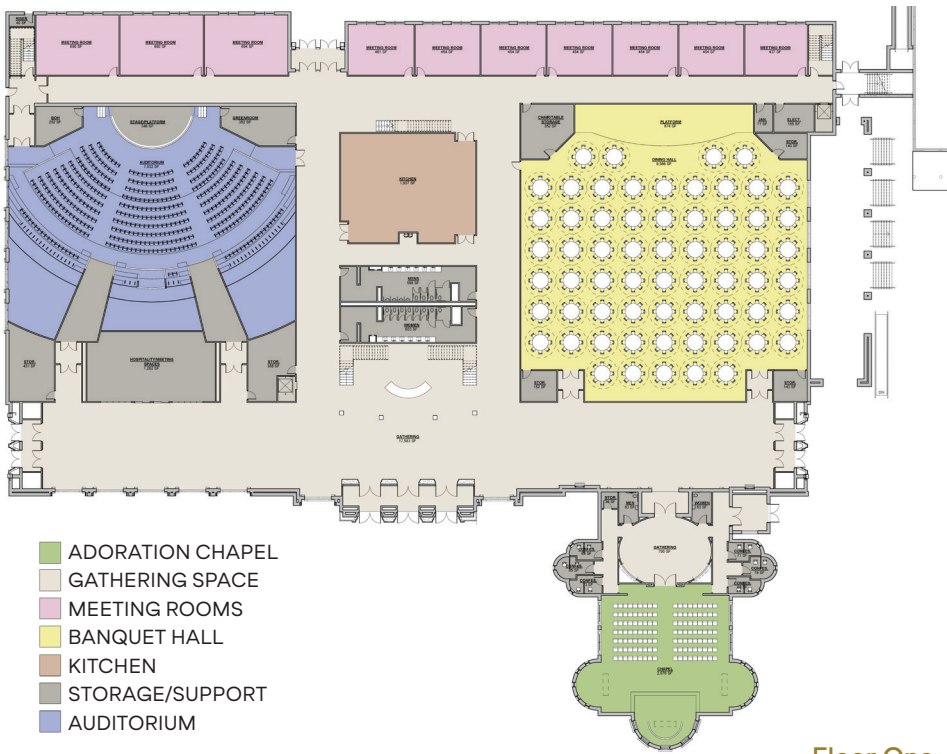

Floor One

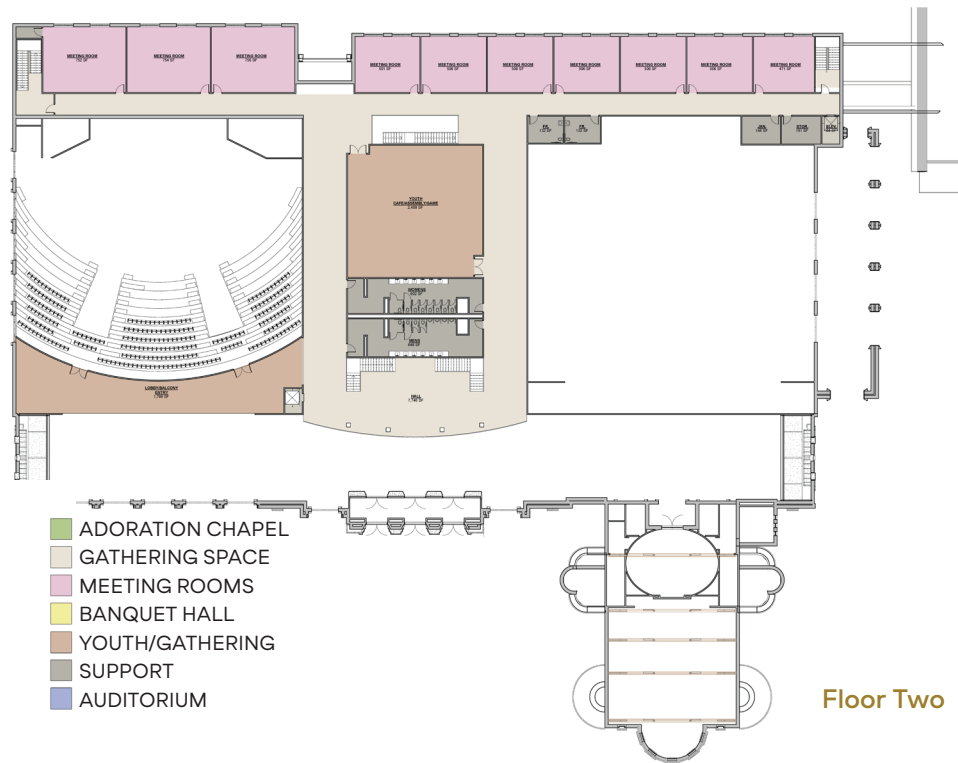

Floor Two



2

New Rectory | \$2.5 Million

- Six living suites – each with a bedroom, bathroom and study – to accommodate our priests, visiting priests and seminarians
- Shared spaces including a private chapel for Mass, an updated kitchen, a formal dining area and comfortable living area
- Demolition of the existing rectory to make way for 96 new parking spaces close to the church
- A new build located on the western side of our campus

3

Parish Center Renovations | \$2.5 Million

- Reconfiguration of space to improve safety, security and navigation, as well as to make best use of available space
- Relocation of Kids Day Out and nursery to the east wing of the Parish Center to provide better space configuration, security and traffic flow, as well as provide improved nursery experience for Mass
- Renovations to the Great Hall to improve aesthetics, usability, and technology
- Expansion and relocation of parish offices to the west wing of the Parish Center to provide workspace and storage for existing and planned staff

EXPANDING CATHOLIC EDUCATION

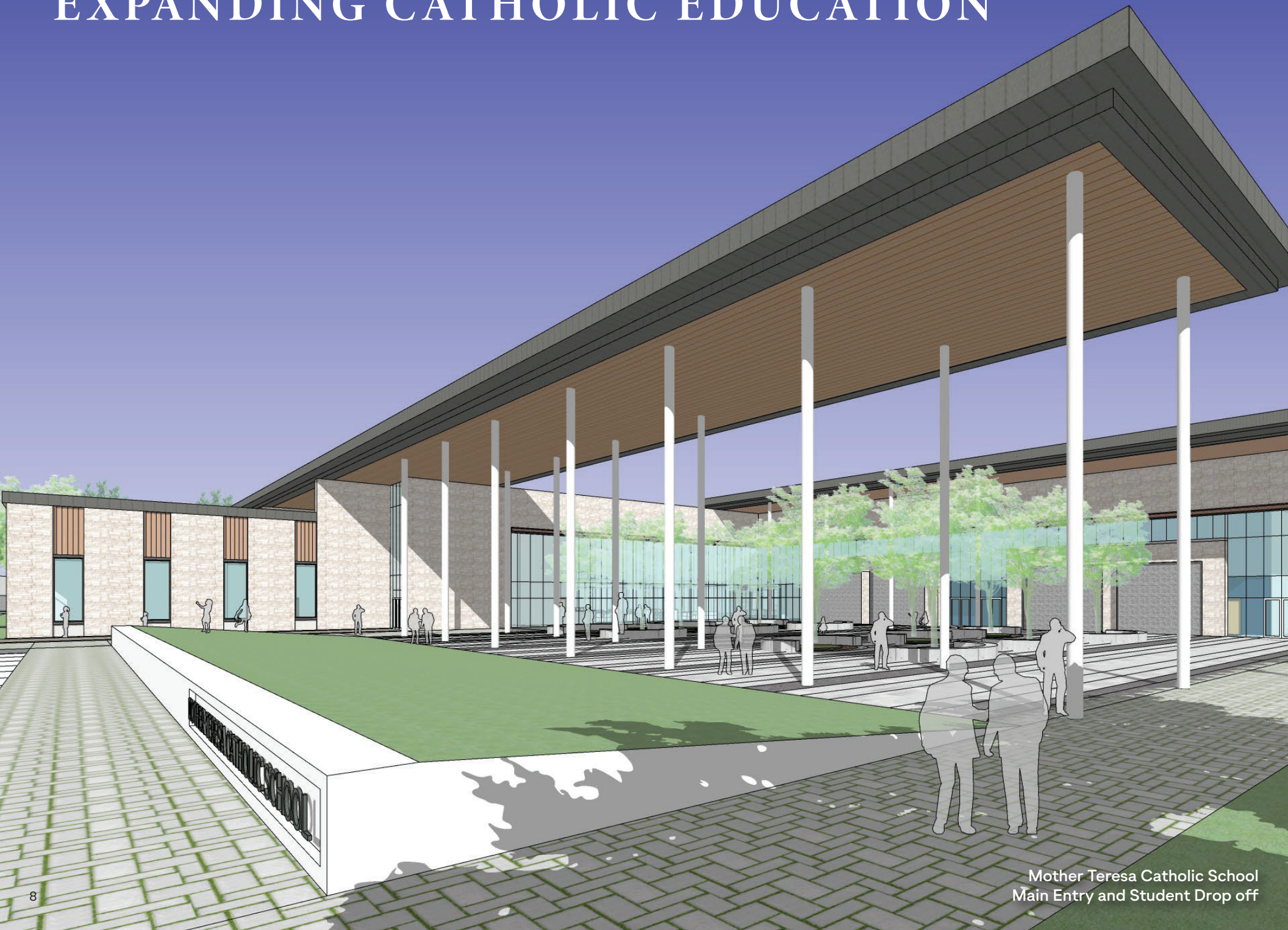

Mother Teresa Catholic School
Main Entry and Student Drop off

Funding For Mother Teresa Catholic School

| 10% of Funds Raised

- A new Pre-K-8th Catholic school located at the northwest corner of Independence and Main in Frisco
- Will provide St. Francis families with an affordable, faith-based, Catholic school option in a location that is accessible to most parishioners
- Bishop Burns has asked St. Francis to lead the charge in fundraising, providing a positive example for other parishes in the area that will be asked to do the same in the near future



Mother Teresa Catholic School
Chapel Courtyard



WHY YOUR GIFT MATTERS NOW

As St. Francis embarks on this important fundraising effort, your support matters now more than ever. Your generosity will help us determine how much of our plan we will be able to complete immediately and how many of these needed changes will have to be deferred until a later time. Our architect and general contractor have provided construction tiers that allow for flexibility in funding and work to meet the most urgent needs of the parish.

FOUNDATION GOAL \$22 MILLION

To ensure that the foundation is laid to meet our most urgent needs, funding at this level will allow for:

- Partial completion of the Family Life Center with the auditorium and first-floor meeting rooms completed, but the banquet hall, second-floor meeting rooms, youth space and adoration chapel constructed, but not completed
- Completion of a new rectory to house all our priests, visiting priests and seminarians comfortably, and demolition of existing rectory to increase parking near the church
- Funding of our obligation to Mother Teresa Catholic School

CELEBRATION GOAL \$33 MILLION

At this level, St. Francis of Assisi will be able to celebrate the completion of several much-needed projects, including:

- Partial completion of the Family Life Center, with the auditorium, all meeting rooms and youth space completed, and the banquet hall and adoration chapel constructed, but not completed
- Completion of a new rectory to house all our priests, visiting priests and seminarians comfortably, and demolition of existing rectory to increase parking near the church
- Partial renovation of the Parish Center to improve meeting spaces and parish offices
- Funding of our obligation to Mother Teresa Catholic School

VICTORY GOAL \$44 MILLION

Reaching this goal will allow St. Francis of Assisi to realize the full vision of the first phase of our long-range plan, including:

- Complete buildout and furnishings for the Family Life Center, encompassing the new banquet hall, auditorium, all meeting rooms, kitchen, dedicated youth area and adoration chapel
- Completion of a new rectory to house all of our priests, visiting priests and seminarians comfortably, and demolition of existing rectory to increase parking near the church
- Renovation of the Parish Center to improve meeting spaces, the parish offices and Kids Day Out
- Funding of our obligation to Mother Teresa Catholic School

*“Start by doing what is necessary, then what is possible, and suddenly you are doing the impossible.”
– St. Francis of Assisi*

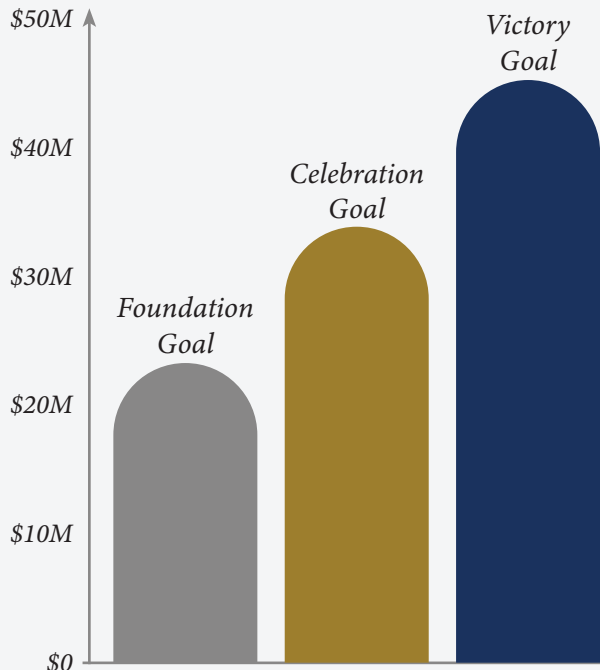

FUNDING THESE PLANS

These plans for our campus are ambitious and do not come at low costs. However, these are the facilities that our parish will require to meet the needs of our parish community for generations to come. Parish leaders hope to raise the bulk of the funds required for construction through the *I Am with You Always* Capital Campaign. By raising these funds now, the parish can avoid increased debt and be able to direct more funding to ministries and parish programs. If St. Francis is not able to raise all the needed funds, parish leadership is exploring alternative financing options, including construction loans, construction bonds, and the potential long-term lease of excess parish land. For more information on these options, visit stfoafrisco.org/capitalcampaign.



 **8,948**
Active Total
Registered Households

 **9,138**
Average Total Weekly
Mass Attendance

 **55+**
Ministries

 **108**
Weddings

 **269**
Infant Baptisms

 **61**
Funerals

 **500+**
Hours of Ministry
Meetings Each Month

 **1,626**
Enrolled in Origin
Faith Formation
K-5: 602
6-8: 413
9-12: 336
Adults: 275

 **106**
Enrolled
in OCIA/RICA

**All statistics listed reflect July 2023-June 2024*

CURRENT CAPACITY vs. PLANNED CAPACITY



| | CURRENT CAPACITY | PLANNED CAPACITY |
|----------------------------|------------------|------------------|
| Banquet Hall | 360 people | 500 people |
| Auxiliary Worship Space | 630 people | 800 people |
| Meeting Rooms | 9 rooms | 29 rooms |
| Offices | 10 offices | 25 offices |
| Dedicated Youth Space | 500 sq ft | 2,409 sq ft |





“We are truly blessed and have grown in our faith through the ACTS community at St. Francis. Our experiences through ACTS have led us into many different ministries and provided us abundant opportunities to grow in our faith. What once seemed like an enormous church full of strangers, now feels like home!

This Capital Campaign gives us the opportunity to expand and provide the much needed space for our growing parish. The amazing new facilities give us the opportunity to continue living and growing in our faith as a parish family now and for generations to come!”

*Jason and Emily Bednarz
campaign general chairs*



WAYS TO GIVE

There are many options to help meet your needs while supporting St. Francis in a meaningful way. Selecting the best gift plan depends on your personal financial situation and goals. You may want to consider stretching pledges over a three-year period to maximize the total amount of support. This commitment can be fulfilled through monthly, quarterly, semiannual or annual installments.

Pledges are commitments made in good faith. Because tax laws change and each situation is unique, donors are encouraged to consult with their financial advisor to determine which method of contributing is most beneficial.

We encourage all donors to consider a 10-20% initial payment to begin your commitment to ensure we will have the required cash on hand to begin construction in 2025.

Cash or Check

Gifts made by cash or check are the most common and will allow St. Francis to address its immediate needs. Checks should be made payable to St. Francis of Assisi Catholic Church and include *I Am with You Always* in the memo line.

Online Giving

By using the St. Francis online giving portal, you can securely access your account any time to view and make changes to your account information, preferred bank account or credit/debit card payment methods, and gift processing schedule.

To set up your pledge online, visit stfoafrisco.org/capitalcampaign and click on the “Make Your Pledge” link. Additional enrollment information or assistance is available at the parish finance office.

Gifts of Securities

Gifts of stocks, bonds or mutual funds are encouraged when supporters want to make a charitable gift and avoid capital gains tax. Please reach out to Kathleen Hastings in the finance office at khastings@stfoafrisco.org for delivery details to share with your brokerage provider to complete your gift to the *I Am with You Always* Capital Campaign.

Direct Qualified Charitable Distribution from a Retirement Account

Benefactors can make charitable gifts using funds from tax-deferred individual retirement accounts (IRAs). Donors may use this strategy to satisfy part, or all, of their required minimum distribution and lower overall tax liability to benefit St. Francis.

Planned Gifts

Planned gifts provide opportunities to make a meaningful commitment to the campaign now as part of your financial and estate planning. Such gifts can allow donors to accomplish charitable giving goals and take advantage of tax laws. Opportunities may include:

- Bequests from a will or a living trust
- Life insurance
- Real estate
- Designating St. Francis as a beneficiary (for example, brokerage transfer on death agreement, retirement account beneficiaries or life insurance beneficiaries)
- Various trust options (for example, a charitable lead trust)

This information is not intended as legal advice. You are advised to consult your own qualified professional advisor for specific recommendations.



“We are excited to embark on this capital campaign to enhance our church campus to accommodate the tremendous growth at St. Francis. Much-needed expansions to worship areas, meeting rooms, event space, classrooms, offices, and housing are required to support our mission to proclaim the gospel to all of creation. It is our turn to ensure St. Francis has the infrastructure capable of serving the Catholic community in the Frisco area for decades to come.”



*Terry and Michelle Pelzel
campaign general chairs*



*“For it is in giving that we receive.”
– St. Francis of Assisi*

THREE-YEAR GIFT CHART

This chart serves as a guide as you prayerfully consider your level of support.

| Total Gift | Initial 10% Gift | Remaining Balance | Monthly | Quarterly | Semi-Annually | Annually |
|------------|------------------|-------------------|---------|-----------|---------------|----------|
| \$250,000 | \$25,000 | \$225,000 | \$6,250 | \$18,750 | \$37,500 | \$75,000 |
| \$150,000 | \$15,000 | \$135,000 | \$3,750 | \$11,250 | \$22,500 | \$45,000 |
| \$75,000 | \$7,500 | \$67,500 | \$1,875 | \$5,625 | \$11,250 | \$22,500 |
| \$50,000 | \$5,000 | \$45,000 | \$1,250 | \$3,750 | \$7,500 | \$15,000 |
| \$30,000 | \$3,000 | \$27,000 | \$750 | \$2,250 | \$4,500 | \$9,000 |
| \$25,000 | \$2,500 | \$22,500 | \$625 | \$1,875 | \$3,750 | \$7,500 |
| \$18,000 | \$1,800 | \$16,200 | \$450 | \$1,350 | \$2,700 | \$5,400 |
| \$15,000 | \$1,500 | \$13,500 | \$375 | \$1,125 | \$2,250 | \$4,500 |
| \$12,000 | \$1,200 | \$10,800 | \$300 | \$900 | \$1,800 | \$3,600 |
| \$9,000 | \$900 | \$8,100 | \$225 | \$675 | \$1,350 | \$2,700 |
| \$7,500 | \$750 | \$6,750 | \$188 | \$563 | \$1,125 | \$2,250 |
| \$4,500 | \$450 | \$4,050 | \$113 | \$338 | \$675 | \$1,350 |
| \$3,000 | \$300 | \$2,700 | \$75 | \$225 | \$450 | \$900 |

Note: *The incremental payment examples are based on an initial 10% investment followed by the preferred payment plan for three years. St. Francis’ needs are immediate. We respectfully ask you, if possible, to consider making a 10% to 20% initial investment on your commitment.*



PLEDGING VERSUS A ONE-TIME GIFT

Most gifts to a campaign come through pledges or one-time donations. Please consider the following testimonies regarding the advantage and mindful stewardship approach pledging offers versus making a one-time gift.



“My family has been a part of two different campaigns with two different parishes over the years – as we’ve moved a couple of times with my job. At the first parish, early in our marriage, my wife and I gave a one-time gift. It felt like we gave a lot toward the campaign; especially, for the income we were making between our jobs. At the second parish, we were asked to consider “making a pledge rather than giving a one-time donation.” It didn’t seem, when we were asked, that there was much of a difference between the two, but there was... and is.”

“When we gave the one-time gift for the first campaign it hurt the wallet a bit. It put a little dent in our checking account, but it was done. When we made the pledge for the second campaign it was more about considering how we (and then, with our kids) would have to change something or do without some things for a while, to make a sacrifice while we were fulfilling the pledge.”

“More than anything, when we pledged, versus making a one-time donation, we felt more invested in the project and what was going on at the parish. It wasn’t a “one and done and move on” thing. I believe making a pledge is a more thoughtful process. It means taking inventory of what we have and what we have been blessed with and giving back to God – not giving once and being done but giving continuously like He gives to us.”



The I Am with You Always campaign will allow our beautiful and diverse parish to meet the needs of our programs and ministries as we continue to grow. If every parishioner supports St. Francis with a sacrificial gift, we will be able to provide better experiences for our children and youth, more opportunities for fellowship and spiritual growth, and a better living environment for our priests who do so much for our parish.

Enrique Arochi and Elizabeth Gutierrez de Arochi campaign general chairs

| Commemorative Opportunity | Ask Amount | Recognition |
|--|--------------------|---------------------------------|
| FAMILY LIFE CENTER (entire building) | \$5,000,000 | Signage on Building |
| Bell Tower | \$1,250,000 | Plaque on Wall |
| Outdoor Gallery | \$500,000 | Plaque on Wall |
| Gathering Area | \$500,000 | Plaque on Wall |
| Outdoor Plaza | \$500,000 | Outdoor Signage |
| Second Floor Terrace | \$500,000 | Plaque on Wall |
| Kitchen | \$500,000 | Plaque Outside Room |
| Large Meeting Room (6) | \$250,000 | Plaque Outside Room |
| Family Life Center Entrance | \$250,000 | Plaque Inside Entrance |
| Elevator (2) | \$250,000 | Plaque Outside Elevator |
| Outdoor Fountain (4) | \$150,000 | Outdoor Signage |
| Small Meeting Room (14) | \$100,000 | Plaque Outside Room |
| Gathering Area Windows (5) | \$50,000 | Plaque by Window |
| Youth Assembly Room | \$500,000 | Plaque Outside Room |
| AUDITORIUM (entire facility inside FLC) | \$3,500,000 | Signage Outside Facility |
| Auditorium Balcony | \$1,000,000 | Plaque on Wall |
| Welcome Center | \$500,000 | Plaque Outside Room |
| Stage | \$500,000 | On Donor Wall |
| Green Room/Sacristy | \$ 50,000 | Plaque Outside Room |
| Audio System | \$ 100,000 | On Donor Wall |
| Altar | \$ 100,000 | On Donor Wall Claimed! |
| Crucifix | \$ 100,000 | On Donor Wall Claimed! |
| Windows | \$85,000 | Plaque by Window |
| Ambo | \$50,000 | On Donor Wall |
| Chalice/Paten | \$50,000 | On Donor Wall |
| Tabernacle | \$50,000 | On Donor Wall Claimed! |
| Presiders Chairs (2) | \$50,000 | On Donor Wall |
| Credence Table | \$50,000 | On Donor Wall |
| BANQUET HALL (entire facility inside FLC) | \$1,250,000 | Signage Outside Facility |
| ADORATION CHAPEL (entire facility inside FLC) | \$2,000,000 | Signage Outside Facility |
| Stained Glass Windows (6) (2) 4 of 6 Claimed! | \$75,000 | Plaque by Window |
| Adoration Chapel Pews (10) | \$50,000 | Plaque |
| Altar | \$100,000 | On Donor Wall |
| Crucifix | \$100,000 | On Donor Wall Claimed! |
| Confessional (6) (5) 1 of 6 Claimed! | \$50,000 | Plaque Outside Room |
| Chandelier (6) | \$50,000 | Plaque |
| Audio System | \$50,000 | Plaque |
| Tabernacle/Monstrance | \$150,000 | Plaque Claimed! |
| Presiders Chair | \$50,000 | Plaque |
| Ambo | \$50,000 | Plaque |
| PARISH CENTER | | |
| KDO Classroom (10) | \$75,000 | Plaque Outside Room |
| Priest Office (4) | \$50,000 | Plaque Outside Room |
| Business Office (6) | \$50,000 | Plaque Outside Room |
| Faith Formation Office (4) | \$50,000 | Plaque Outside Room |
| Youth Office (4) | \$50,000 | Plaque Outside Room |
| RECTORY (entire building) | \$2,000,000 | Signage on Building |
| Priests' Chapel | \$200,000 | Plaque on Wall Claimed! |
| Priest Suite (6) | \$100,000 | Plaque on Wall |
| Kitchen | \$100,000 | Plaque on Wall Claimed! |

I AM *with you* ALWAYS CAPITAL CAMPAIGN LEADERSHIP

PASTOR

Fr. Rudy Garcia

GENERAL CHAIRS

Enrique and Elizabeth Arochi
Jason and Emily Bednarz
Loren and Christie Lacy
Terry and Michelle Pelzel

HONORARY CHAIRS

Charlie Donnor
Dennis and Joyce Houlihan
Fr. Larry Pichard
Tom and Jan Schleim

CAMPAIGN CABINET

Vinny and Monica Bedus
Matt and Amy Booterbaugh
Biagio and Elisa Cucco
Greg and Tanya Deiter
Todd and Carmen Fahrenthold
Tim and Dunree Files
Adam and Gina Gallutia
Soy and Liji Joseph
Kevin and Amy Klimczyk
Mike and Karen Martin
Kenny and Yarin Mazingo
Pedro and Gabby Ortega
Tommy and Mercy Rosales
Tim and Kathy Terzis
John and Angela Wegerzyn

PARISH LEADERSHIP TEAM

Deacon Alex Barbieri
Kristie Gates
Lauren Hartsock
Tim Truss

DEVELOPMENT COUNSEL

Steier Group

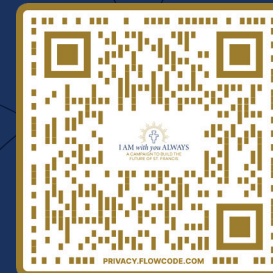

*¿Se habla español?
Ver este documento
en español.*



ST. FRANCIS OF ASSISI
CATHOLIC CHURCH

8000 Eldorado Parkway
Frisco, TX 75033
(972) 712 2645

stfoafrisco.org
campaign@stfoafrisco.org
facebook.com/stfoafrisco
instagram.com/stfoafrisco/
youtube.com/@stfrancisofassisifrisco